



Location: Fullerton, Orange County

Timeframe: 2009 - 2010

Project Partners: City of Fullerton

Project Services

- Model development
- Community presentation
- Training

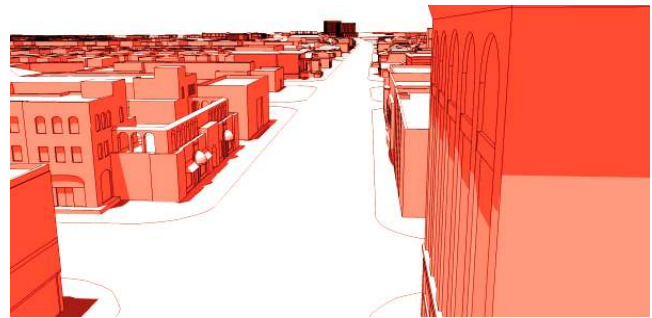

This Demonstration Project provided funding for the creation of a three-dimensional digital model and database of the Downtown Fullerton area surrounding the transportation center to serve as an analytical and communication tool for development.

Goals

- Improve communication of land use and development patterns to stakeholders
- Assist in analyzing land use alternatives
- Allow for detailed analysis of existing conditions and more accurate projects for future growth

This project constructed a system that could be integrated into a common geographic information system (GIS) format to provide detailed and accurate representations of buildings, public infrastructure, and transportation systems within the area located ½ mile from the City's multi-modal transportation center. The Downtown 3D Digital Model and Database will provide a rich visualization tool and planning resource for the City of Fullerton allowing for visual walkthroughs and flythroughs; the ability to insert new development scenarios into the model; and allowing for the visualization of data not represented on the Specific Plan.

Results

- Improved information sharing with the public through visual walkthroughs and virtual services
- Included visualizations of data that is not represented in Specific Plan
- 3D-model development
 - Digitized building (and structural) footprints & heights
 - 3D massing and detailing